

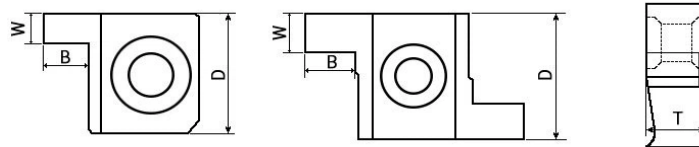

## GR GROOVING





ITEM DESCRIPTION	Dimension (mm)				Insert	
	W	B	D	R	AS9030	AS1007
6GR 100	1.00	1.50	6.44	0.2	•	•
6GR 150	1.50	1.50	6.44	0.2	•	•
6GR 200	2.00	1.50	6.44	0.2	•	•
7GR 100	1.00	1.50	7.36	0.2	•	•
7GR 150	1.50	1.50	7.36	0.2	•	•
7GR 200	2.00	1.50	7.36	0.2	•	•
8GR 100	1.00	2.00	10.16	0.2	•	•
8GR 150	1.50	2.00	10.16	0.2	•	•
8GR 200	2.00	2.00	10.16	0.2	•	•
8GR 250	2.50	2.00	10.16	0.2	•	•
8GR 300	3.00	2.00	10.16	0.2	•	•
9GR 100	1.00	3.00	12.95	0.2	•	•
9GR 150	1.50	3.00	12.95	0.2	•	•
9GR 200	2.00	3.00	12.95	0.2	•	•
9GR 250	2.50	3.00	12.95	0.2	•	•
9GR 300	3.00	3.00	12.95	0.2	•	•

## GR GROOVING BORING BAR

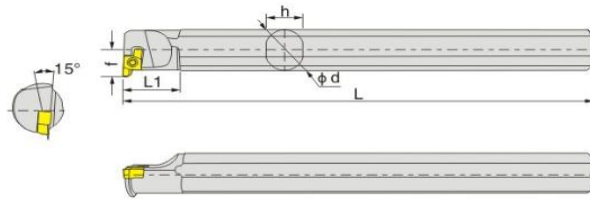
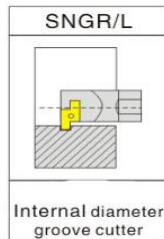
### SNGR/L



Model	Insert 	Applicable conditions						Accessories  	
		Tmax	$\phi d$	F	L1	L	H	Screw	Wrench
S08H-SNGR/L06	6GR/L	2	8	4.7	15	100	7	M2.2×4	T7
S08H-SNGR/L07	7GR/L	2	8	5.8	15	100	7	M2.5×6	T7
S10K-SNGR/L07	7GR/L	2	10	6.8	15	125	8	M2.5×6	T7
S10K-SNGR/L08	8GR/L	3.5	10	7.6	20	125	8	M2.5×6	T7
S12M-SNGR/L08	8GR/L	3.5	12	8.6	20	150	11	M2.5×6	T7
S16Q-SNGR/L09	9GR/L	3.5	16	11.6	20	180	14.8	M2.5×6	T8
S20R-SNGR/L09	9GR/L	3.5	20	13.6	20	200	18.4	M2.5×6	T8
H08H-SNGR/L06	6GR/L	2	8	4.7	15	100	7	M2.2×4	T7
H08H-SNGR/L07	7GR/L	2	8	5.8	15	100	7	M2.5×6	T7
H10K-SNGR/L07	7GR/L	2	10	6.8	15	125	8	M2.5×6	T7
H10K-SNGR/L08	8GR/L	3.5	10	7.6	20	125	8	M2.5×6	T7
H12M-SNGR/L08	8GR/L	3.5	12	8.6	20	150	11	M2.5×6	T7
H16Q-SNGR/L09	9GR/L	3.5	16	11.6	20	180	14.8	M2.5×6	T8
H20R-SNGR/L09	9GR/L	3.5	20	13.6	20	200	18.4	M2.5×6	T8